

GRIPRIGHT® TEST PLUG (10"-16") - TECHNICAL SPECIFICATIONS

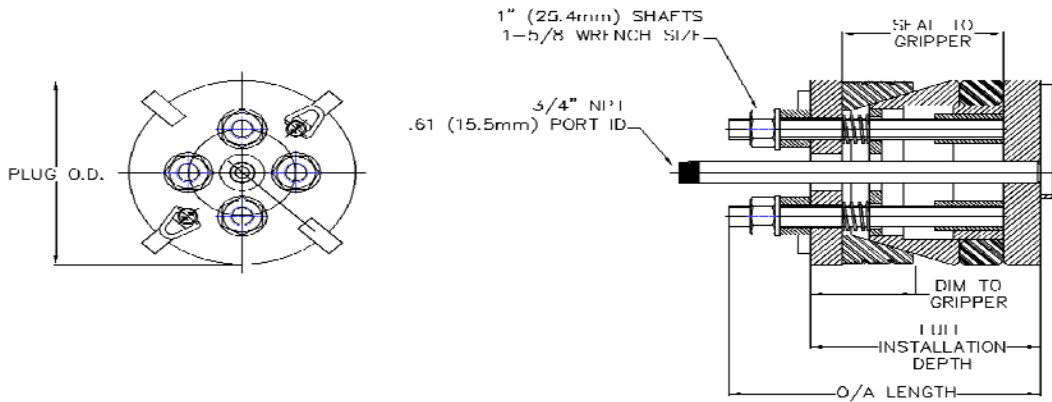

PART NUMBER	GRIPRIGHT SIZE	PIPE SCHEDULE	I.D. SIZE RANGE		I.D. SIZE RANGE		PLUG OD		UNDERCUT FROM MINIMUM PIPE		MAXIMUM TEST PRESSURE (1)		SHAFT QTY	OVERALL LENGTH		SEAL TO GRIPPER		DIM TO GRIPPER		FULL INSTALLATION DEPTH		APPROXIMATE WEIGHT				
			(in)	(in)	(mm)	(mm)	(in)	(mm)	(in)	(mm)	(psi)	(Bar)		(in)	(mm)	(in)	(mm)	(in)	(mm)	(in)	(mm)	(lbs)	(kg)			
GT-10P100	10"	sch 100	9.28	9.59	235.7	243.6	9.13	231.9	.15	3.8	3993	274.1	4	12	304.8	5.96	151.4	4	1/8	104.8	8.71	221.2	150	68.0		
GT-10P80		sch 80	9.53	9.80	242.1	248.9	9.38	238.3	.15	3.8	3264	224.0	12	304.8	5.95	151.1	4	1/8	104.8	8.70	221.0					
GT-10PXS		sch 60/xs	9.72	9.97	246.9	253.2	9.57	243.1	.15	3.8	2725	187.0	11	3/4	298.5	5.94	150.9	4	1/8	104.8	8.44	214.4				
GT-10P40		sch 40/std	9.99	10.21	253.7	259.3	9.84	249.9	.15	3.8	1966	134.9	11	3/4	298.5	5.92	150.4	4	1/8	104.8	8.42	213.9				
GT-10P30		sch 30	10.10	10.31	256.5	261.9	9.96	253.0	.14	3.6	1645	112.9	11	3/4	298.5	5.91	150.1	4	1/8	104.8	8.41	213.6				
GT-10P20		sch 20	10.22	10.41	259.6	264.4	10.07	255.8	.15	3.8	1333	91.5	11	3/4	298.5	5.90	149.9	4	3/8	111.1	8.65	219.7				
GT-10P10		sch 10s	10.39	10.56	263.9	268.2	10.24	260.1	.15	3.8	873	59.9	11	3/4	298.5	5.90	149.9	4	3/8	111.1	8.65	219.7				
GT-10P5		sch 5	10.45	10.61	265.4	269.5	10.30	261.6	.15	3.8	707	48.5	11	3/4	298.5	5.89	149.6	4	3/8	111.1	8.64	219.5				
GT-12P80		sch 80	11.34	11.64	288.0	295.7	11.19	284.2	.15	3.8	3184	218.5	4	12	311.2	6.45	163.8	4	5/8	117.5	9.45	240.0			200	90.6
GT-12P60		sch 60	11.59	11.86	294.4	301.2	11.45	290.8	.14	3.6	2577	176.9	12	1/4	311.2	6.44	163.6	4	5/8	117.5	9.44	239.8				
GT-12PXS	xs	11.72	11.97	297.7	304.0	11.57	293.9	.15	3.8	2282	156.6	12	1/4	311.2	6.43	163.3	4	5/8	117.5	9.43	239.5					
GT-12P40	sch40/std	11.91	12.19	302.5	309.6	11.82	300.2	.09	2.3	1840	126.3	12	3/4	304.8	6.42	163.1	4	7/8	123.8	9.42	239.3					
GT-12P30	sch 30	12.06	12.27	306.3	311.7	11.91	302.5	.15	3.8	1487	102.1	12	3/4	304.8	6.41	162.8	4	7/8	123.8	9.41	239.0					
GT-12P20	sch 20	12.22	12.41	310.4	315.2	12.07	306.6	.15	3.8	1120	76.9	12	3/4	304.8	6.40	162.6	4	7/8	123.8	9.40	238.8					
GT-12P10	sch 10s/5	12.36	12.57	313.9	319.3	12.21	310.1	.15	3.8	802	55.0	12	3/4	304.8	6.40	162.6	4	7/8	123.8	9.39	238.5					
GT-14P140	sch 140	11.47	11.91	291.3	302.5	11.32	287.5	.15	3.8	5438	373.2	6	12	3/4	323.9	7.09	180.1	5	1/2	127.0	10.59	269.0	275	124.6		
GT-14P120	sch 120	11.78	12.18	299.2	309.4	11.63	295.4	.15	3.8	4713	323.5	12	3/4	323.9	7.06	179.3	5	1/2	127.0	10.56	268.2					
GT-14P100	sch 100	12.09	12.45	307.1	316.2	11.94	303.3	.15	3.8	4001	274.6	12	1/2	317.5	7.04	178.8	5	1/2	127.0	10.29	261.4					
GT-14P80	sch 80	12.47	12.78	316.7	324.6	12.32	312.9	.15	3.8	3160	216.9	12	1/4	311.2	7.02	178.3	5	1/4	133.4	10.27	260.9					
GT-14P60	sch 60	12.78	13.05	324.6	331.5	12.63	320.8	.15	3.8	2476	169.9	12	1/4	311.2	7.00	177.8	5	1/2	139.7	10.50	266.7					
GT-14PXS	xs	12.97	13.22	329.4	335.8	12.82	325.6	.15	3.8	2071	142.1	12	1/4	311.2	6.99	177.5	5	1/2	139.7	10.49	266.4					
GT-14P40	sch 40	13.09	13.33	332.5	338.6	12.94	328.7	.15	3.8	1807	124.0	12	1/4	311.2	6.98	177.3	5	1/2	139.7	10.48	266.2					
GT-14PSTD	sch 30/std	13.22	13.44	335.8	341.4	13.07	332.0	.15	3.8	1540	105.7	12	1/4	311.2	6.98	177.3	5	1/2	139.7	10.48	266.2					
GT-14P20	sch 20	13.34	13.55	338.8	344.2	13.20	335.3	.14	3.6	1276	87.6	12	3/4	304.8	6.97	177.0	5	1/2	139.7	10.22	259.6					
GT-14P10	sch 10/10s/5	13.47	13.82	342.1	351.0	13.44	341.4	.03	0.8	1018	69.9	12	3/4	304.8	6.96	176.8	5	3/4	146.1	10.46	265.7					
GT-16P120	sch 120	13.53	13.96	343.7	354.6	13.38	339.9	.15	3.8	4587	314.8	8	13	1/4	336.6	7.50	190.5	5	1/2	139.7	11.55	293.4	350	158.6		
GT-16P100	sch 100	13.91	14.29	353.3	363.0	13.76	349.5	.15	3.8	3839	263.5	13	3/4	330.2	7.52	191.0	5	1/2	139.7	11.27	286.3					
GT-16P80	sch 80	14.28	14.62	362.7	371.3	14.13	358.9	.15	3.8	3109	213.4	12	3/4	323.9	7.50	190.5	5	3/4	146.1	11.25	285.8					
GT-16P60	sch 60	14.66	14.95	372.4	379.7	14.51	368.6	.15	3.8	2390	164.0	12	1/2	317.5	7.48	190.0	6	1/2	152.4	11.23	285.2					
GT-16P40	sch 40/xs	14.97	15.22	380.2	386.6	14.82	376.4	.15	3.8	1805	123.9	12	1/4	311.2	7.46	189.5	6	1/2	152.4	10.96	278.4					
GT-16PSTD	sch 30/std	15.22	15.44	386.6	392.2	15.07	382.8	.15	3.8	1343	92.2	12	1/4	311.2	7.45	189.2	6	1/2	152.4	10.95	278.1					
GT-16P20	sch 20	15.34	15.55	389.6	395.0	15.20	386.1	.14	3.6	1113	76.4	13	3/4	349.3	7.44	189.0	6	1/4	158.8	11.19	284.2					
GT-16P10	sch 10/10s/5	15.47	15.81	392.9	401.6	15.32	389.1	.15	3.8	889	61.0	13	3/4	349.3	7.44	189.0	6	1/4	158.8	11.19	284.2					

Notes:
 (1) NEVER use a test pressure greater than the weakest component in the system can handle. Test Pressure specified in table is equivalent to 80% of the pressure that will yield ASTM A106 Grade B pipe.
 The test pressure for higher and lower strength pipes will differ proportionally. The maximum test pressure for higher strength pipe must never exceed the highest test pressure listed for that pipe O.D.
 For plug sizes used to test tubing, use of these GripTight sizes in tubing with a minimum yield strength of 35ksi, the maximum test pressure is estimated by the test pressure listed for the equivalent or next larger pipe O.D.
 with the equivalent or next thinner wall thickness. The test pressure for higher and lower strength tubes will differ proportionally. The maximum test pressure for higher strength tubes must never exceed the highest test pressure listed for the equivalent or next larger pipe size. NEVER use a test pressure greater than the weakest component in the system can safely handle.

 EST Group	EST Group 2701 Township Line Rd Hatfield, PA 19440-1770 USA (P) 215.721.1100 800.355.7044 (F) 215.721.1101 est-info@curtisswright.com http://estgroup.cwfc.com	Europe / Middle East / Africa EST Group B.V. Hoorn 312a 2404 HL Alphen aan den Rijn The Netherlands (P) +31.172.418841 (F) +31.172.418849 est-emea@curtisswright.com	Asia EST Group Asia 35 Tannery Rd, #11-10 Tannery Block Ruby Industrial Complex Singapore 247740 (P) +65.6745.8560 (F) +65.6742.8700 est-asia@curtisswright.com
----------------------	--	--	---

GRIP TIGHT® TEST PLUG (18"-24") - TECHNICAL SPECIFICATIONS

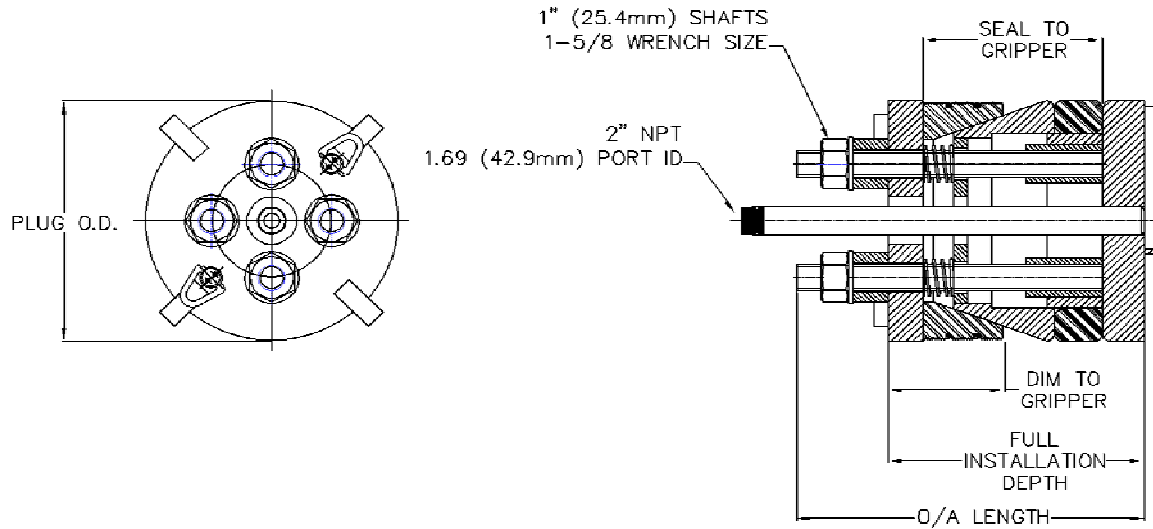

PART NUMBER	NOM PIPE SIZE	PIPE SCHEDULE	I.D. SIZE RANGE		I.D. SIZE RANGE		PLUG OD		UNDERCUT FROM MINIMUM PIPE I.D.		MAXIMUM TEST PRESSURE (1)		SHAFT QTY	OVERALL LENGTH		SEAL TO GRIPPER		DIM TO GRIPPER		FULL INSTALLATION DEPTH		APPROXIMATE WEIGHT					
			(in)	(in)	(mm)	(mm)	(in)	(mm)	(in)	(mm)	(psi)	(Bar)		(in)	(mm)	(in)	(mm)	(in)	(mm)	(in)	(mm)	(lbs)	(kg)				
GT-18P120	18"	sch 120	15.22	15.69	386.6	398.5	15.07	382.8	.15	3.8	4600	315.7	8	15	381.0	8.12	206.2	6 1/4	158.8	12.62	320.5	500	226.6				
GT-18P100		sch 100	15.66	16.07	397.8	408.2	15.51	394.0	.15	3.8	3825	262.5		14 3/4	374.7	8.09	205.5	6 1/4	158.8	12.34	313.4						
GT-18P80		sch 80	16.09	16.45	408.7	417.8	15.94	404.9	.15	3.8	3069	210.6		14 1/2	368.3	8.06	204.7	6 1/2	165.1	12.31	312.7						
GT-18P60		sch 60	16.47	16.78	418.3	426.2	16.32	414.5	.15	3.8	2430	166.8		14 1/4	362.0	8.04	204.2	6 3/4	171.5	12.29	312.2						
GT-18P40		sch 40	16.84	17.11	427.7	434.6	16.70	424.2	.14	3.6	1803	123.7		14	355.6	8.02	203.7	6 3/4	171.5	12.02	305.3						
GT-18PXS		xs	16.97	17.22	431.0	437.4	16.82	427.2	.15	3.8	1599	109.7		14	355.6	8.01	203.5	6 3/4	171.5	12.01	305.1						
GT-18P30		sch 30	17.09	17.33	434.1	440.2	16.94	430.3	.15	3.8	1396	95.8		13 3/4	349.3	8.01	203.5	7	177.8	12.01	305.1						
GT-18PSTD		std	17.22	17.44	437.4	443.0	17.07	433.6	.15	3.8	1191	81.7		13 3/4	349.3	8.00	203.2	7	177.8	12.00	304.8						
GT-18P20		sch 20	17.34	17.55	440.4	445.8	17.20	436.9	.14	3.6	987	67.7		13 3/4	349.3	7.99	202.9	7	177.8	11.99	304.5						
GT-18P10		sch 10/10s/5	17.47	17.81	443.7	452.4	17.32	439.9	.15	3.8	789	54.2		13 3/4	349.3	7.99	202.9	7	177.8	11.99	304.5						
GT-20P100	20"	sch 100	17.41	17.88	442.2	454.2	17.26	438.4	.15	3.8	3814	261.8	10	15 1/4	387.4	8.60	218.4	6 3/4	171.5	13.35	339.1	625	283.2				
GT-20P80		sch 80	17.91	18.32	454.9	465.3	17.76	451.1	.15	3.8	3035	208.3		14 3/4	374.7	8.57	217.7	7	177.8	13.07	332.0						
GT-20P60		sch 60	18.34	18.70	465.8	475.0	18.20	462.3	.14	3.6	2366	162.4		14 1/2	368.3	8.55	217.2	7	177.8	12.80	325.1						
GT-20P40		sch 40	18.78	19.09	477.0	484.9	18.63	473.2	.15	3.8	1713	117.6		14 1/4	362.0	8.52	216.4	7 1/4	184.2	12.77	324.4						
GT-20PXS		sch 30xs	18.97	19.25	481.8	489.0	18.82	478.0	.15	3.8	1435	98.5		14	355.6	8.51	216.2	7 1/4	184.2	12.51	317.8						
GT-20PSTD		sch 20/std	19.22	19.47	488.2	494.5	19.07	484.4	.15	3.8	1070	73.4		14	355.6	8.50	215.9	7 1/2	190.5	12.75	323.9						
GT-20P10		sch 10/10s/5	19.47	19.80	494.5	502.9	19.32	490.7	.15	3.8	709	48.7		14	355.6	8.49	215.6	7 1/2	190.5	12.74	323.6						
GT-22P100		22"	sch 100	19.22	19.72	488.2	500.9	19.00	482.6	.22	5.6	3717		255.1	10	17 3/4	450.9	9.38	238.3	7 1/8	181.0			14.13	358.9	850	385.1
GT-22P80			sch 80	19.72	20.16	500.9	512.1	19.50	495.3	.22	5.6	3009		206.5		17 1/2	444.5	9.35	237.5	7 3/8	187.3			14.10	358.1		
GT-22P60			sch 60	20.22	20.59	513.6	523.0	20.00	508.0	.22	5.6	2316		159.0		17	431.8	9.32	236.7	7 5/8	193.7			13.82	351.0		
GT-22PXS	sch 30xs		20.97	21.25	532.6	539.8	20.75	527.1	.22	5.6	1302	89.4	16 1/2	419.1		9.28	235.7	7 7/8	200.0	13.53	343.7						
GT-22PSTD	sch 20/std		21.22	21.47	539.0	545.3	21.00	533.4	.22	5.6	971	66.6	16 1/4	412.8		9.27	235.5	8 1/8	206.4	13.52	343.4						
GT-22P10	sch 10/10s/5		21.47	21.80	545.3	553.7	21.25	539.8	.22	5.6	644	44.2	16 1/4	412.8		9.26	235.2	8 1/8	206.4	13.51	343.2						
GT-24P100	24"		sch 120	20.34	20.95	516.6	532.1	20.13	511.3	.21	5.3	4543	311.8	12		18 1/4	463.6	9.98	253.5	8 1/8	206.4	15.73	399.5	1073	486.2		
GT-24P100			sch 100	20.91	21.45	531.1	544.8	20.69	525.5	.22	5.6	3798	260.7			18	457.2	9.94	252.5	8 3/8	212.7	15.69	398.5				
GT-24P80			sch 80	21.53	21.99	546.9	558.5	21.31	541.3	.22	5.6	2985	204.9			17 1/2	444.5	9.99	253.7	8 5/8	219.1	15.49	393.4				
GT-24P60			sch 60	22.03	22.43	559.6	569.7	21.81	554.0	.22	5.6	2352	161.4			16 3/4	425.5	9.97	253.2	9 1/8	231.8	15.22	386.6				
GT-24P40		sch 40	22.59	22.92	573.8	582.2	22.37	568.2	.22	5.6	1651	113.3	16 3/4		425.5	9.94	252.5	9 1/8	231.8	15.19	385.8						
GT-24P30		sch 30	22.84	23.14	580.1	587.8	22.63	574.8	.21	5.3	1342	92.1	16 3/4		425.5	9.92	252.0	9 1/8	231.8	15.42	391.7						
GT-24PXS		xs	22.97	23.25	583.4	590.6	22.75	577.9	.22	5.6	1191	81.7	16 3/4		425.5	9.92	252.0	9 1/8	231.8	15.17	385.3						
GT-24PSTD		sch 20/std	23.22	23.47	589.8	596.1	23.00	584.2	.22	5.6	889	61.0	16 3/4		425.5	9.90	251.5	9 3/8	238.1	15.40	391.2						
GT-24P10		sch 10/5	23.47	23.74	596.1	603.0	23.25	590.6	.22	5.6	589	40.4	16 3/4		425.5	9.89	251.2	9 3/8	238.1	15.39	390.9						

Notes:

(1) NEVER use a test pressure greater than the weakest component in the system can handle. Test Pressure specified in table is equivalent to 80% of the pressure that will yield ASTM A106 Grade B pipe. The test pressure for higher and lower strength pipes will differ proportionally. The maximum test pressure for higher strength pipe must never exceed the highest test pressure listed for that pipe O.D. For plug sizes used to test tubing, use of these GripTight sizes in tubing with a minimum yield strength of 35ksi, the maximum test pressure is estimated by the test pressure listed for the equivalent or next larger pipe O.D. with the equivalent or next thinner wall thickness. The test pressure for higher and lower strength tubes will differ proportionally. The maximum test pressure for higher strength tubes must never exceed the highest test pressure listed for the equivalent or next larger pipe size. NEVER use a test pressure greater than the weakest component in the system can safely handle.

	EST Group 2701 Township Line Rd Hatfield, PA 19440-1770 USA (P) 215.721.1100 800.355.7044 (F) 215.721.1101 est-info@curtisswright.com http://estgroup.cwfc.com	Europe / Middle East / Africa EST Group B.V. Hoorn 312a 2404 HL Alpen aan den Rijn The Netherlands (P) +31.172.418841 (F) +31.172.418849 est-emea@curtisswright.com	Asia EST Group Asia 35 Tannery Rd, #11-10 Tannery Block Ruby Industrial Complex Singapore 247740 (P) +65.6745.8560 (F) +65.6742.8700 est-asia@curtisswright.com
--	--	---	---